

PHOTOVOLTAIC MODULE

JJ-M660

Features:

- High efficiency multi crystalline silicon solar cells.
- All materials of Lamination are UL approved.
- High transmission textured toughened glass.
- Module as per IEC-61215(2005); IEC-61730 safety class & IEC-61701 Salt Mist Test.
- Suitable for off-grid & grid connected systems.
- Narrow power tolerance for minimizing losses due to module power mismatch in an array.
- High quality screwless anodized aluminum frame to provide structural strength to the Laminate.
- TUV approved, IP65 rated 4 terminal junction box with 3 by-pass diodes (15A, Schottky) for quick and safe installation.
- Bypass diodes to reduce the effect of partial shading of modules.
- Preassembled cable length 1000 mm each with MC4 type +Ve and –Ve connectors.
- Safe packing depending on mode of transport.
- Manufacturing facility certified to ISO 9001:2008, ISO 14001:2004, BS OHSAS 18001:2007 and EN ISO 50001:2011.

Typical Electrical Characteristics*:

Module Type	JJ-M660				
Maximum Power [P _m (Wp)]	235	240	245	250	255
Power tolerance [%]	± 3	± 3	± 3	± 3	± 3
Maximum Power Voltage [V _{mp} (V)]	28.56	28.92	29.31	29.77	30.18
Maximum Power Current [I _{mp} (A)]	8.23	8.30	8.36	8.40	8.45
Open Circuit Voltage [V _{oc} (V)]	36.52	36.65	36.75	37.04	37.45
Short Circuit Current [I _{sc} (A)]	8.62	8.73	8.87	8.96	8.98
Module Efficiency [%]	14.36	14.66	14.97	15.22	15.58

All electrical measurements are at STC (25°C, 1.5AM, 1000W/m²).

*Best in Class A Solar Sun simulator (As per IEC 60904-9).

Thermal Characteristics:

Temperature coefficient of P_{max}	-0.43%/°K
Temperature coefficient of I_{sc}	0.046%/°K
Temperature coefficient of V_{oc}	-0.33%/°K
NOCT	45 ± 2 °C

Mechanical Characteristics:

Front Cover	Low Iron tempered glass
Solar Cells (Quantity/type/arrangement/size)	60 pcs/Multicrystalline/6 x 10/156 mm x 156 mm
Junction Box	TUV approved, IP65 rated 4 terminal junction box with 3 by-pass diodes (15 A, Schottky)
Cable (length/size)	1000 mm/ 4.0mm ²
Connectors	MC4 type +Ve and -Ve
Dimensions (LxWxH)	1643 mm x 996 mm x 40 mm (± 1 mm)
Weight	20 kg approximate

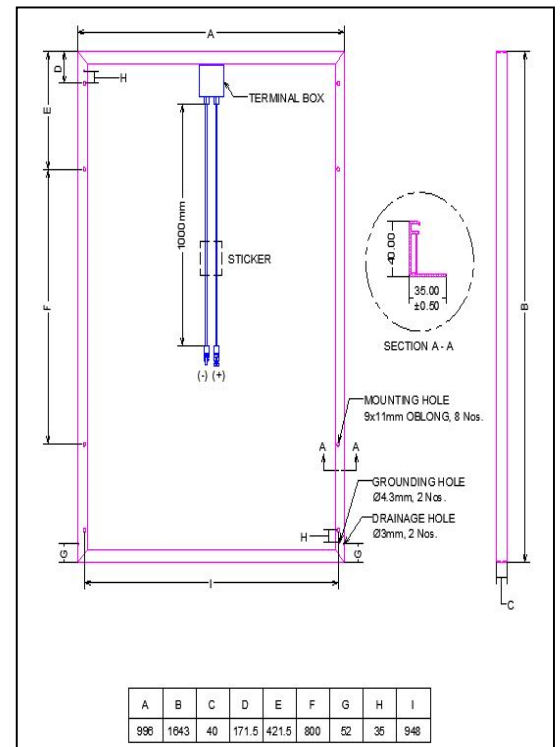

Operating Conditions:

Max. System Voltage	1000 V _{DC}
Safety Class	II
Maximum Series fuse	15A
Operating Temperature	-40°C to +85°C

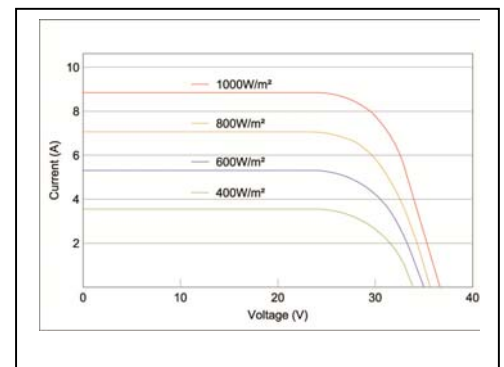

Warranty:

- Manufacturing defect & workmanship: 5 Years
- Power Production (Limited Warranty): 90% : 10 years & 80% : 25 years
- In compliance with our warranty terms and conditions. Contact Jain Irrigation System Ltd. for complete warranty details.
- For any kind of technical or design support, you may contact Jain Irrigation System Ltd.

Above Specifications are subject to change without prior notice. The specifications may vary slightly.